

CARPORT PRICES

Prices include GST

Delivery charges apply

Prices correct as a 01/09/2010

W X L X H	GABLE
	Colorbond®
3.2 x 6.0 x 2.4	\$2,260
3.6 x 6.0 x 2.4	\$2,370
6.0 x 6.0 x 2.4	\$2,900
7.5 x 6.0 x 2.4	\$3,320
6.0 x 9.0 x 2.4	\$4,090

11 deg roof pitch

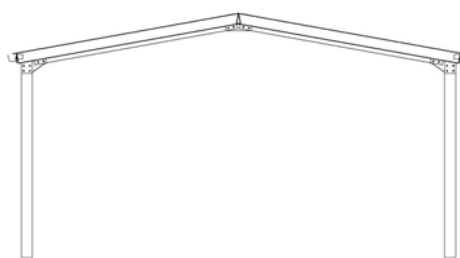

Options on gable carports:

2.7m high

add 5% to above base prices

3.0m high

add 10% to above base prices

22.5 deg pitch

add \$150 to overall price

W X L X H	FLAT
	Colorbond®
3.2 x 6.0 x 2.64 - 2.40	\$1,990
3.6 x 6.0 x 2.70 - 2.40	\$2,100
5.4 x 6.0 x 2.85 - 2.40	\$2,620
6.0 x 6.0 x 2.90 - 2.40	\$2,870
6.0 x 9.0 x 2.90 - 2.40	\$3,980
7.5 x 9.0 x 3.05 - 2.40	\$4,810

5 deg roof pitch



Notes on all carports:

Columns and trusses (rafters) use C150.19 C-section or greater and are fully bolted

Columns (posts) are concreted into ground 600mm minimum

Price includes engineers plans & specs (Form 55)

Gutter included with a 300mm skirt underneath

Downpipe pops included

Gable ends are left open